

# TIPO N ELETTRICITÀ MONOBOBINA PER TRAZIONE E SPINTA

## TYPE N SINGLE COIL ELECTROMAGNETS FOR PUSH-PULL ACTION

ALIMENTAZIONE 24 VCC – 110 VCC O CON VOLTAGGIO A RICHIESTA  
 STANDARD 24 VDC – 110 VDC OR VOLTAGE ON REQUEST

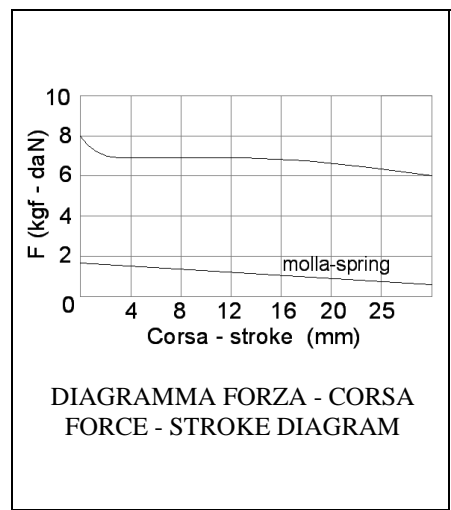
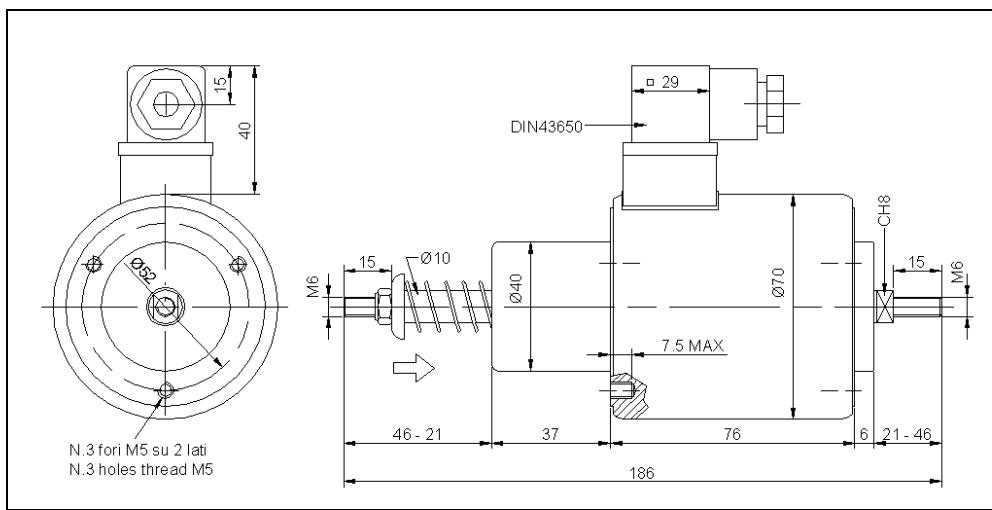
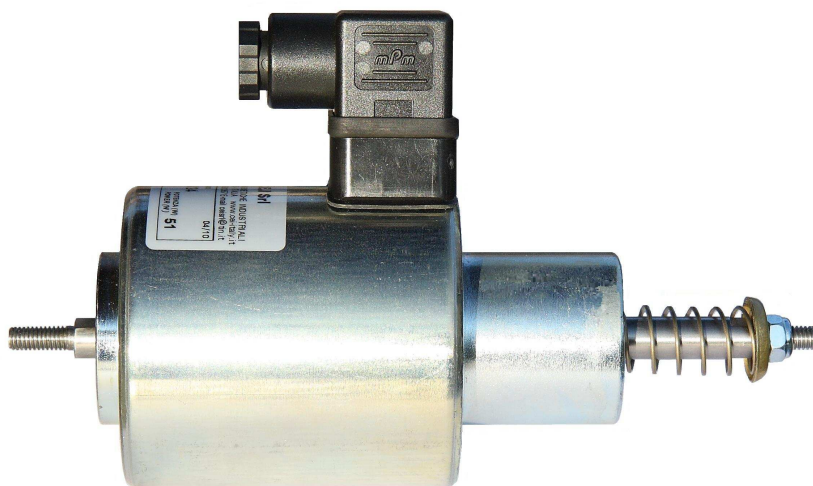

### CARATTERISTICHE TECNICHE TECHNICAL SPECIFICATIONS

Tipo Type	Tensione – Voltage (V)	Consumo - Power (W)	Corsa – Stroke (mm)	Forza * – Force * (Kg)	Servizio - Duty (ED%)	Protezione – Protection	Peso – Weight (Kg)
<b>N70V24</b>	24	50	25	5	100	IP40	2.2
<b>N70V110</b>	110	51	25	5	100	IP40	2.2

(\*) Forza con molla – Force with spring (T=20°C)

1 Kg = 9.81 N



## COSTRUZIONI ELETTRICITÀ INDUSTRIALI

C.SO P. LEVI, 7- RIVOLI – TORINO (ITALY) – TEL.0039 011 9594446 - FAX 0039 011 9591357 www.cei-italy.it e-mail: ceisrl@tin.it